

Appendix F

Traffic Memorandum (2025)



4542 Ruffner Street
Suite 100
San Diego, CA 92111
858.300.8800 r
www.llgengineers.com

Pasadena
Irvine
San Diego

MEMORANDUM

To: Ms. Bibiana Sparks
ACORN Environmental

Date: August 26, 2025

From: John Boarman, P.E.
LLG, Engineers

LLG Ref: 3-25-4095

Subject: **Native Oaks Village**

The Native Oaks Village, formerly known as Liberty Bell Plaza, site is located on the northeast corner of the Valley Center Road / Mirar De Valle intersection in the County of San Diego. The approved traffic study assumed the construction of an 85,000 square foot (sf) neighborhood shopping center anchored by a grocery store and the project was approved by the County of San Diego. Linscott, Law & Greenspan (LLG) completed a traffic study for the subject project in July 2019. The purpose of this memo is to confirm whether or not conditions have changed in such a way that would require additional traffic analysis and/or revisiting the efficacy of the traffic mitigation measures identified in 2019.

The project has since been reduced to 76,891 sf. Based on the trip rate 120 ADT/1,000 sf that was used in the approved traffic study, the total trips have been reduced by 973 ADT from what was approved. There were two mitigation measures in the 2019 traffic study as summarized below:

- **Valley Center Road / Project Driveway / Mirar De Valle Road intersection** - Install a traffic signal and provide the following lane geometry.
 - *Northbound*: provide one (1) exclusive left-turn lane, one (1) exclusive thru lane and one (1) shared thru/right-turn lane.
 - *Southbound*: provide one (1) exclusive left-turn lane, one (1) exclusive thru lane and one (1) shared thru/right-turn lane.
 - *Eastbound*: provide one (1) exclusive left-turn lane, one (1) shared left/thru lane and one (1) exclusive right-turn lane.
 - *Westbound*: provide one (1) exclusive left-turn lane and one (1) shared thru/right-turn lane (20 feet wide).

- **Valley Center Road segment between Thudernut Lane/N. Lake Wohlford Road and Cole Grade Road** – Provide a westbound right-turn lane at the Valley Center Road / Cole Grade Road intersection.

The westbound right-turn lane has been installed at the Valley Center Road / Cole Grade Road intersection. Portions of the mitigation at the Valley Center Road / Mirar

De Valle intersection have been implemented and the balance have been designed and approved by the County of San Diego. The entire intersection improvements will be built prior to the opening of the shopping center.

Based on the locations that will be most impacted and carry the most traffic generated by the project, the three segments along Valley Center Road listed in *Table A* were counted in June 2025. As shown in *Table A*, the volumes have increased by an average of 21%. This is largely due to the construction of several cumulative projects in the area such as Park Circle, 318 units, (as identified in the 2019 traffic study) and general traffic growth.

Figure 1 shows a map with the segment locations along with the ADTs.

While the area's traffic counts have increased, the total trips generated by the project have decreased overall. It should be noted that the 2019 traffic study analyzed project impacts and identified mitigation measures that included traffic generated by numerous cumulative projects. The current traffic volumes on Valley Center Road are consistent with the forecasted volumes in the 2019 study cumulative conditions.

The conclusions of the prior traffic study would not be expected to change based on the current conditions and the decrease in project generated traffic.

Please call me with any questions.

Thank you

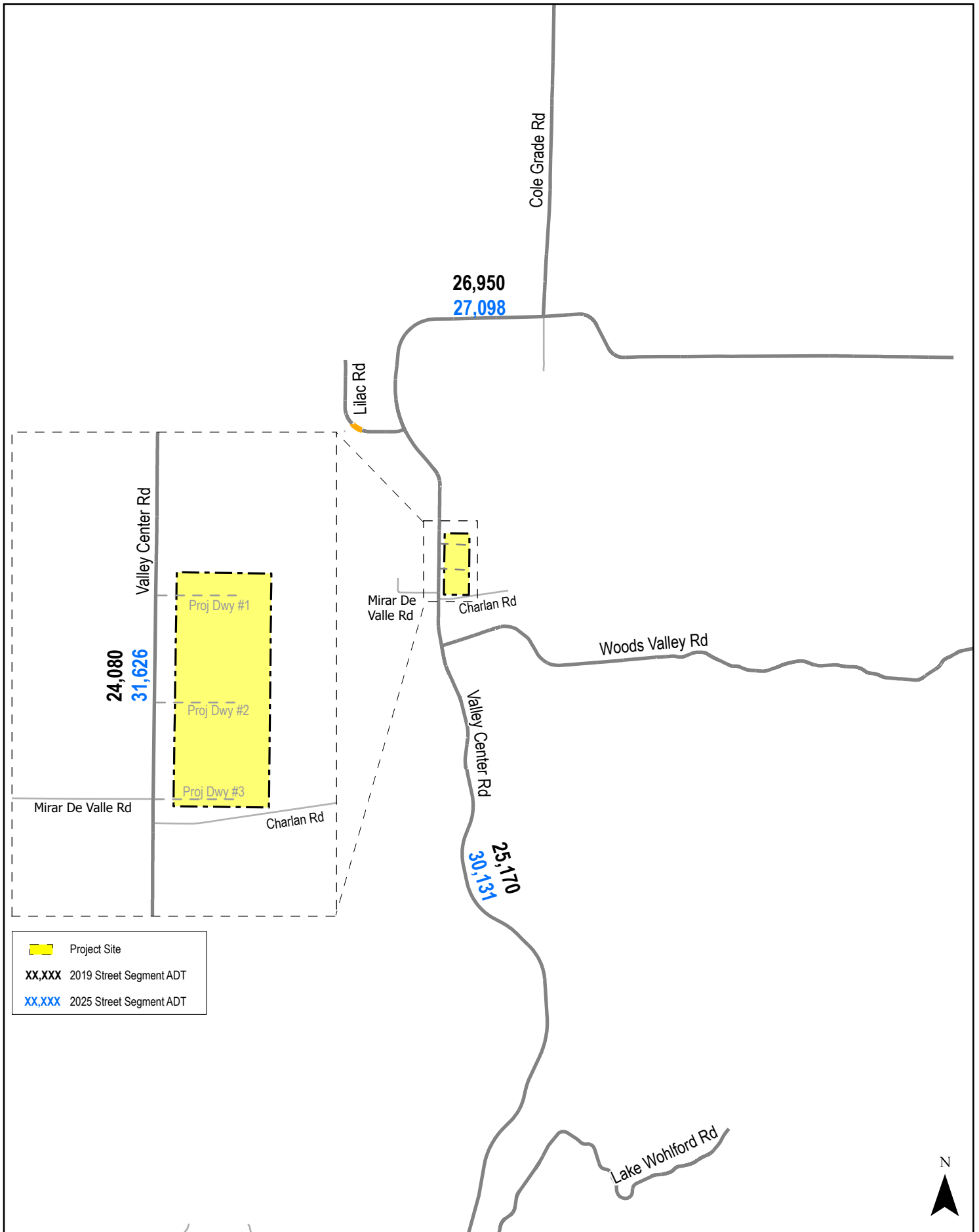

TABLE A
STREET SEGMENT COMPARISON

Street Segment	2019 ^b	2025 ^c	Δ ^d
	ADT ^a	ADT	% Increase
Valley Center Road			
Cole Grade Rd to Lilac Rd	26,950	27,098	0.55%
Lilac Rd to Mirar De Valle Rd	24,080	31,626	31.33%
Woods Valley Rd to Escondido City Limits	25,170	30,131	19.71%

Footnotes:

- a. ADT - Average Daily Traffic Volumes.
- b. SOURCE: LLG Traffic Study, July 2019. *Attachment A* contains the July 2019 counts.
- c. SOURCE: Traffic Counts, June 2025. *Attachment B* contains the June 2025 counts.
- d. Δ denotes the increase in percentage from the 2019 counts to the 2025 counts.



N:\4095\Figure
Date: 8/14/2025

Figure 1
Existing Traffic Volumes Comparison

MEMORANDUM

ATTACHMENT A

VOLUME

Valley Center Rd Bet. Cole Grade Rd & Lilac Rd

Day: Tuesday
Date: 6/12/2018

City: Valley Center
Project #: CA18_4224_003

DAILY TOTALS					NB	SB	EB	WB	Total		
					13,441	13,504	0	0	26,945		
AM Period	NB	SB	EB	WB	TOTAL	PM Period	NB	SB	EB	WB	TOTAL
00:00	24	34			58	12:00	197	212			409
00:15	19	47			66	12:15	194	175			369
00:30	22	22			44	12:30	200	233			433
00:45	16	81	37	140	53	12:45	208	799	248	868	456
01:00	4	28			32	13:00	212	221			433
01:15	9	23			32	13:15	237	177			414
01:30	9	22			31	13:30	176	181			357
01:45	20	42	15	88	35	13:45	222	847	203	782	425
02:00	8	30			38	14:00	208	231			439
02:15	5	19			24	14:15	235	196			431
02:30	2	21			23	14:30	253	223			476
02:45	8	23	23	93	31	14:45	229	925	215	865	444
03:00	4	20			24	15:00	280	245			525
03:15	11	18			29	15:15	241	233			474
03:30	10	28			38	15:30	286	241			527
03:45	9	34	16	82	25	15:45	260	1067	220	939	480
04:00	6	32			38	16:00	256	201			457
04:15	11	33			44	16:15	289	203			492
04:30	26	63			89	16:30	264	244			508
04:45	35	78	55	183	90	16:45	264	1073	277	925	541
05:00	31	72			103	17:00	274	226			500
05:15	54	106			160	17:15	268	235			503
05:30	76	140			216	17:30	263	194			457
05:45	86	247	175	493	261	17:45	245	1050	150	805	395
06:00	114	205			319	18:00	256	143			399
06:15	141	215			356	18:15	223	156			379
06:30	167	225			392	18:30	250	124			374
06:45	166	588	200	845	366	18:45	228	957	122	545	350
07:00	196	217			413	19:00	191	124			315
07:15	224	228			452	19:15	141	113			254
07:30	211	276			487	19:30	184	105			289
07:45	235	866	288	1009	523	19:45	176	692	87	429	263
08:00	179	278			457	20:00	145	110			255
08:15	167	256			423	20:15	144	80			224
08:30	157	225			382	20:30	145	84			229
08:45	143	646	194	953	337	20:45	114	548	101	375	215
09:00	145	199			344	21:00	112	82			194
09:15	140	137			277	21:15	120	105			225
09:30	169	188			357	21:30	136	85			221
09:45	167	621	206	730	373	21:45	79	447	65	337	144
10:00	154	214			368	22:00	92	78			170
10:15	162	201			363	22:15	88	83			171
10:30	156	217			373	22:30	61	67			128
10:45	155	627	173	805	328	22:45	48	289	51	279	99
11:00	147	187			334	23:00	59	50			109
11:15	173	189			362	23:15	56	49			105
11:30	195	196			391	23:30	42	43			85
11:45	186	701	181	753	367	23:45	36	193	39	181	75
TOTALS	4554		6174		10728	TOTALS	8887		7330		16217
SPLIT %	42.4%		57.6%		39.8%	SPLIT %	54.8%		45.2%		60.2%

DAILY TOTALS					NB	SB	EB	WB	Total
					13,441	13,504	0	0	26,945

AM Peak Hour	07:00	07:30			07:15	PM Peak Hour	15:30	16:30		16:30	
AM Pk Volume	866	1098			1919	PM Pk Volume	1091	982		2052	
Pk Hr Factor	0.921	0.953			0.917	Pk Hr Factor	0.944	0.886		0.948	
7 - 9 Volume	1512	1962	0	0	3474	4 - 6 Volume	2123	1730	0	0	3853
7 - 9 Peak Hour	07:00	07:30			07:15	4 - 6 Peak Hour	16:15	16:30			16:30
7 - 9 Pk Volume	866	1098	0	0	1919	4 - 6 Pk Volume	1091	982	0	0	2052
Pk Hr Factor	0.921	0.953	0.000	0.000	0.917	Pk Hr Factor	0.944	0.886	0.000	0.000	0.948

VOLUME

Valley Center Rd Bet. Lilac Rd & Mirar De Valle Rd

Day: Tuesday
Date: 6/12/2018

City: Valley Center
Project #: CA18_4224_005

DAILY TOTALS					NB	SB	EB	WB	Total		
					11,773	12,306	0	0	24,079		
AM Period	NB	SB	EB	WB	TOTAL	PM Period	NB	SB	EB	WB	TOTAL
00:00	32	27			59	12:00	188	181			369
00:15	18	38			56	12:15	173	171			344
00:30	23	23			46	12:30	179	197			376
00:45	16	89	32	120	48	12:45	189	729	196	745	385
01:00	8	25			33	13:00	181	175			356
01:15	10	24			34	13:15	205	183			388
01:30	13	20			33	13:30	180	162			342
01:45	14	45	15	84	29	13:45	187	753	173	693	360
02:00	8	26			34	14:00	190	192			382
02:15	8	17			25	14:15	187	185			372
02:30	7	17			24	14:30	200	198			398
02:45	10	33	20	80	30	14:45	208	785	169	744	377
03:00	6	17			23	15:00	209	191			400
03:15	9	16			25	15:15	211	212			423
03:30	9	28			37	15:30	218	209			427
03:45	10	34	14	75	24	15:45	210	848	203	815	413
04:00	6	29			35	16:00	230	202			432
04:15	15	32			47	16:15	213	189			402
04:30	27	59			86	16:30	221	215			436
04:45	36	84	64	184	100	16:45	219	883	242	848	461
05:00	38	83			121	17:00	229	203			432
05:15	59	112			171	17:15	236	222			458
05:30	75	158			233	17:30	192	184			376
05:45	85	257	195	548	280	17:45	210	867	147	756	357
06:00	104	195			299	18:00	209	143			352
06:15	115	218			333	18:15	209	142			351
06:30	149	212			361	18:30	202	130			332
06:45	140	508	199	824	339	18:45	195	815	124	539	319
07:00	148	187			335	19:00	178	122			300
07:15	152	199			351	19:15	150	96			246
07:30	190	210			400	19:30	172	104			276
07:45	196	686	248	844	444	19:45	163	663	82	404	245
08:00	137	227			364	20:00	142	100			242
08:15	131	216			347	20:15	154	80			234
08:30	132	210			342	20:30	119	73			192
08:45	111	511	176	829	287	20:45	115	530	100	353	215
09:00	124	201			325	21:00	118	74			192
09:15	116	158			274	21:15	135	96			231
09:30	146	161			307	21:30	123	81			204
09:45	140	526	186	706	326	21:45	95	471	62	313	157
10:00	131	208			339	22:00	96	65			161
10:15	141	191			332	22:15	90	76			166
10:30	132	191			323	22:30	60	57			117
10:45	141	545	142	732	283	22:45	49	295	55	253	104
11:00	130	173			303	23:00	61	38			99
11:15	161	163			324	23:15	48	40			88
11:30	174	158			332	23:30	38	39			77
11:45	167	632	171	665	338	23:45	37	184	35	152	72
TOTALS	3950	5691			9641	TOTALS	7823	6615			14438
SPLIT %	41.0%	59.0%			40.0%	SPLIT %	54.2%	45.8%			60.0%

DAILY TOTALS					NB	SB	EB	WB	Total
					11,773	12,306	0	0	24,079

AM Peak Hour	11:45	07:30			07:15	PM Peak Hour	16:30	16:30	16:30		
AM Pk Volume	707	901			1559	PM Pk Volume	905	882	1787		
Pk Hr Factor	0.940	0.908			0.878	Pk Hr Factor	0.959	0.911	0.969		
7 - 9 Volume	1197	1673	0	0	2870	4 - 6 Volume	1750	1604	0	0	3354
7 - 9 Peak Hour	07:00	07:30			07:15	4 - 6 Peak Hour	16:30	16:30			16:30
7 - 9 Pk Volume	686	901	0	0	1559	4 - 6 Pk Volume	905	882	0	0	1787
Pk Hr Factor	0.875	0.908	0.000	0.000	0.878	Pk Hr Factor	0.959	0.911	0.000	0.000	0.969

VOLUME

Valley Center Rd Bet. Woods Valley Rd & Ridge Ranch Rd

Day: Tuesday
Date: 6/12/2018

City: Valley Center
Project #: CA18_4224_007

DAILY TOTALS					NB	SB	EB	WB	Total		
					12,451	12,717	0	0	25,168		
AM Period	NB	SB	EB	WB	TOTAL	PM Period	NB	SB	EB	WB	TOTAL
00:00	37	28			65	12:00	191	188			379
00:15	22	41			63	12:15	190	182			372
00:30	28	30			58	12:30	174	190			364
00:45	17	104	30	129	47	12:45	181	736	195	755	376
01:00	9	23			32	13:00	218	180			398
01:15	15	28			43	13:15	196	185			381
01:30	12	19			31	13:30	198	162			360
01:45	16	52	14	84	30	13:45	213	825	170	697	383
02:00	7	31			38	14:00	209	189			398
02:15	8	14			22	14:15	204	176			380
02:30	4	19			23	14:30	201	201			402
02:45	11	30	24	88	35	14:45	217	831	172	738	389
03:00	10	15			25	15:00	231	184			415
03:15	8	25			33	15:15	228	205			433
03:30	9	26			35	15:30	217	192			409
03:45	7	34	26	92	33	15:45	220	896	201	782	421
04:00	6	28			34	16:00	233	184			417
04:15	17	35			52	16:15	225	179			404
04:30	26	58			84	16:30	230	195			425
04:45	29	78	62	183	91	16:45	258	946	222	780	480
05:00	32	111			143	17:00	222	217			439
05:15	56	132			188	17:15	232	221			453
05:30	91	174			265	17:30	197	180			377
05:45	91	270	222	639	313	17:45	238	889	155	773	393
06:00	96	241			337	18:00	236	125			361
06:15	110	256			366	18:15	239	130			369
06:30	154	253			407	18:30	238	125			363
06:45	124	484	209	959	333	18:45	204	917	130	510	334
07:00	111	244			355	19:00	193	107			300
07:15	131	225			356	19:15	181	103			284
07:30	184	209			393	19:30	199	91			290
07:45	160	586	259	937	419	19:45	184	757	84	385	268
08:00	128	242			370	20:00	175	92			267
08:15	121	221			342	20:15	163	79			242
08:30	136	229			365	20:30	139	73			212
08:45	116	501	206	898	322	20:45	153	630	86	330	239
09:00	130	195			325	21:00	149	67			216
09:15	115	196			311	21:15	158	87			245
09:30	139	180			319	21:30	134	85			219
09:45	137	521	205	776	342	21:45	106	547	67	306	173
10:00	144	208			352	22:00	114	58			172
10:15	145	202			347	22:15	99	71			170
10:30	134	196			330	22:30	74	60			134
10:45	160	583	175	781	335	22:45	65	352	50	239	115
11:00	156	151			307	23:00	63	45			108
11:15	165	200			365	23:15	60	49			109
11:30	198	156			354	23:30	40	33			73
11:45	159	678	182	689	341	23:45	41	204	40	167	81
TOTALS	3921	6255			10176	TOTALS	8530	6462			14992
SPLIT %	38.5%	61.5%			40.4%	SPLIT %	56.9%	43.1%			59.6%

DAILY TOTALS					NB	SB	EB	WB	Total
					12,451	12,717	0	0	25,168

AM Peak Hour	11:30	05:45			07:15	PM Peak Hour	17:45	16:30			16:30
AM Pk Volume	738	972			1538	PM Pk Volume	951	855			1797
Pk Hr Factor	0.932	0.949			0.918	Pk Hr Factor	0.995	0.963			0.936
7 - 9 Volume	1087	1835	0	0	2922	4 - 6 Volume	1835	1553	0	0	3388
7 - 9 Peak Hour	07:15	07:45			07:15	4 - 6 Peak Hour	16:00	16:30			16:30
7 - 9 Pk Volume	603	951	0	0	1538	4 - 6 Pk Volume	946	855	0	0	1797
Pk Hr Factor	0.819	0.918	0.000	0.000	0.918	Pk Hr Factor	0.917	0.963	0.000	0.000	0.936



MEMORANDUM

ATTACHMENT B

Linscott, Law & Greenspan, Engineers

4542 Ruffner Street, Suite 100, San Diego, CA 92111

Average Daily Traffic

Location: **BC 25-025 A-Valley Center Road between Banbury Drive & Woods Valley Road**

Date: Thursday, June 26, 2025		Total Daily Volume: 30131																				Description: Total Volume	
0:00	1:00	2:00	3:00	4:00	5:00	6:00	7:00	8:00	9:00	10:00	11:00	12:00	13:00	14:00	15:00	16:00	17:00	18:00	19:00	20:00	21:00	22:00	23:00
267	179	159	142	331	940	1435	1691	1651	1518	1707	1638	1770	1732	1880	2172	2150	2149	1850	1337	1216	1032	734	451
80	45	32	34	61	157	338	413	421	376	424	392	389	431	471	551	494	546	479	372	336	270	194	121
77	58	39	37	70	235	348	386	405	390	427	401	494	407	461	536	570	563	461	350	316	287	213	137
58	36	41	29	90	246	366	463	423	364	425	419	461	458	475	563	555	546	459	319	277	261	191	106
52	40	47	42	110	302	383	429	402	388	431	426	426	436	473	522	531	494	451	296	287	214	136	87

Date: Thursday, June 26, 2025		Total Daily Volume: 15135																				Description: Northbound Volume	
0:00	1:00	2:00	3:00	4:00	5:00	6:00	7:00	8:00	9:00	10:00	11:00	12:00	13:00	14:00	15:00	16:00	17:00	18:00	19:00	20:00	21:00	22:00	23:00
112	85	70	50	83	312	435	600	611	584	743	778	878	935	1017	1196	1319	1299	1191	847	769	592	397	232
34	22	14	11	14	57	89	133	137	121	182	169	198	225	243	302	306	320	298	234	195	163	126	71
38	31	15	16	19	79	93	129	145	154	182	194	220	223	254	281	345	349	301	220	184	172	106	69
23	18	20	10	21	77	108	186	160	154	190	191	230	257	260	310	354	341	288	207	193	150	103	56
17	14	21	13	29	99	145	152	169	155	189	224	230	230	260	303	314	289	304	186	197	107	62	36

Date: Thursday, June 26, 2025		Total Daily Volume: 14996																				Description: Southbound Volume	
0:00	1:00	2:00	3:00	4:00	5:00	6:00	7:00	8:00	9:00	10:00	11:00	12:00	13:00	14:00	15:00	16:00	17:00	18:00	19:00	20:00	21:00	22:00	23:00
155	94	89	92	248	628	1000	1091	1040	934	964	860	892	797	863	976	831	850	659	490	447	440	337	219
46	23	18	23	47	100	249	280	284	255	242	223	191	206	228	249	188	226	181	138	141	107	68	50
39	27	24	21	51	156	255	257	260	236	245	207	274	184	207	255	225	214	160	130	132	115	107	68
35	18	21	19	69	169	258	277	263	210	235	228	231	201	215	253	201	205	171	112	84	111	88	50
35	26	26	29	81	203	238	277	233	233	242	202	196	206	213	219	217	205	147	110	90	107	74	51

Report Generated by "Count Data" all rights reserved

Linscott, Law & Greenspan, Engineers

4542 Ruffner Street, Suite 100, San Diego, CA 92111

Average Daily Traffic

Location: **BC 25-025 B-Valley Center Road between Charlan Road & Mirar De Valle Road**

Date: Thursday, June 26, 2025		Total Daily Volume: 31626																				Description: Total Volume	
0:00	1:00	2:00	3:00	4:00	5:00	6:00	7:00	8:00	9:00	10:00	11:00	12:00	13:00	14:00	15:00	16:00	17:00	18:00	19:00	20:00	21:00	22:00	23:00
288	207	161	146	362	1008	1595	1800	1716	1590	1741	1654	1781	1790	1921	2258	2269	2272	1991	1433	1300	1076	796	471
96	55	36	36	64	177	371	438	443	393	429	398	397	441	470	551	533	575	500	409	339	284	223	132
80	65	45	30	75	253	397	462	422	414	433	397	465	436	495	568	587	583	494	369	337	286	221	140
62	41	42	48	103	264	421	452	451	376	438	428	458	460	466	590	591	585	487	337	333	283	209	107
50	46	38	32	120	314	406	448	400	407	441	431	461	453	490	549	558	529	510	318	291	223	143	92

Date: Thursday, June 26, 2025		Total Daily Volume: 16004																				Description: Northbound Volume	
0:00	1:00	2:00	3:00	4:00	5:00	6:00	7:00	8:00	9:00	10:00	11:00	12:00	13:00	14:00	15:00	16:00	17:00	18:00	19:00	20:00	21:00	22:00	23:00
133	102	68	48	82	297	460	584	606	597	752	787	903	972	1086	1274	1404	1425	1318	923	833	658	443	249
49	28	17	11	13	52	86	133	136	132	186	180	201	232	251	308	330	367	330	262	204	190	143	80
41	36	16	10	17	75	108	145	140	154	179	185	225	232	288	311	368	364	310	231	203	173	113	75
24	21	20	16	25	75	122	163	171	154	198	202	228	268	261	341	380	393	316	228	229	173	120	55
19	17	15	11	27	95	144	143	159	157	189	220	249	240	286	314	326	301	362	202	197	122	67	39

Date: Thursday, June 26, 2025		Total Daily Volume: 15622																				Description: Southbound Volume	
0:00	1:00	2:00	3:00	4:00	5:00	6:00	7:00	8:00	9:00	10:00	11:00	12:00	13:00	14:00	15:00	16:00	17:00	18:00	19:00	20:00	21:00	22:00	23:00
155	105	93	98	280	711	1135	1216	1110	993	989	867	878	818	835	984	865	847	673	510	467	418	353	222
47	27	19	25	51	125	285	305	307	261	243	218	196	209	219	243	203	208	170	147	135	94	80	52
39	29	29	20	58	178	289	317	282	260	254	212	240	204	207	257	219	219	184	138	134	113	108	65
38	20	22	32	78	189	299	289	280	222	240	226	230	192	205	249	211	192	171	109	104	110	89	52
31	29	23	21	93	219	262	305	241	250	252	211	212	213	204	235	232	228	148	116	94	101	76	53

Report Generated by "Count Data" all rights reserved

Linscott, Law & Greenspan, Engineers

4542 Ruffner Street, Suite 100, San Diego, CA 92111

Average Daily Traffic

Location: **BC 25-025 C-Valley Center Road between Miller Road & Cole Grade Road**

Date: Thursday, June 26, 2025		Total Daily Volume: 27098																				Description: Total Volume			
0:00	1:00	2:00	3:00	4:00	5:00	6:00	7:00	8:00	9:00	10:00	11:00	12:00	13:00	14:00	15:00	16:00	17:00	18:00	19:00	20:00	21:00	22:00	23:00		
249	162	149	127	285	795	1178	1530	1502	1412	1519	1540	1689	1653	1728	1956	1936	1895	1513	1166	1056	953	683	422		
74	42	38	34	63	137	271	352	403	346	367	368	402	433	409	448	463	511	379	326	319	257	183	113		
72	47	31	30	48	190	263	337	340	362	382	370	463	407	436	463	503	507	371	313	258	266	199	120		
61	37	35	33	80	209	293	422	373	349	387	379	434	398	440	514	529	460	372	268	243	248	174	98		
42	36	45	30	94	259	351	419	386	355	383	423	390	415	443	531	441	417	391	259	236	182	127	91		

Date: Thursday, June 26, 2025		Total Daily Volume: 13554																				Description: Eastbound Volume			
0:00	1:00	2:00	3:00	4:00	5:00	6:00	7:00	8:00	9:00	10:00	11:00	12:00	13:00	14:00	15:00	16:00	17:00	18:00	19:00	20:00	21:00	22:00	23:00		
88	63	53	47	74	293	458	660	623	606	720	748	808	896	923	1048	1102	1076	925	703	634	509	316	181		
27	15	12	16	15	44	95	131	164	126	170	165	203	221	215	227	269	272	225	193	184	154	91	50		
29	24	11	12	8	72	81	127	130	148	178	182	174	213	229	237	299	295	227	187	135	140	86	52		
21	14	13	11	21	72	118	202	153	163	189	177	211	219	241	274	299	261	222	162	152	126	82	46		
11	10	17	8	30	105	164	200	176	169	183	224	220	243	238	310	235	248	251	161	163	89	57	33		

Date: Thursday, June 26, 2025		Total Daily Volume: 13544																				Description: Westbound Volume			
0:00	1:00	2:00	3:00	4:00	5:00	6:00	7:00	8:00	9:00	10:00	11:00	12:00	13:00	14:00	15:00	16:00	17:00	18:00	19:00	20:00	21:00	22:00	23:00		
161	99	96	80	211	502	720	870	879	806	799	792	881	757	805	908	834	819	588	463	422	444	367	241		
47	27	26	18	48	93	176	221	239	220	197	203	199	212	194	221	194	239	154	133	135	103	92	63		
43	23	20	18	40	118	182	210	210	214	204	188	289	194	207	226	204	212	144	126	123	126	113	68		
40	23	22	22	59	137	175	220	220	186	198	202	223	179	199	240	230	199	150	106	91	122	92	52		
31	26	28	22	64	154	187	219	210	186	200	199	170	172	205	221	206	169	140	98	73	93	70	58		

Report Generated by "Count Data" all rights reserved